

Smartlink Lite (Smartlink SI D) + PowerTag

Guia rápida de puesta en marcha

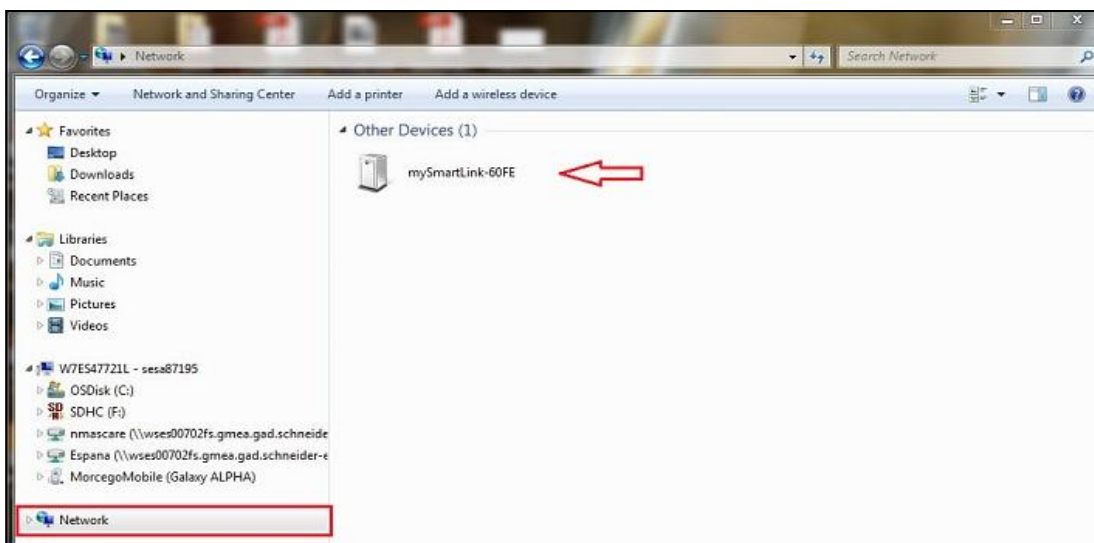

1. Conectar la alimentación en la parte superior del aparato.
2. Con un cable Ethernet (RJ45), conectar el puerto de datos del Smartlink (situado en la parte inferior) a un ordenador con sistema operativo Windows.
Nota: Es recomendable que el ordenador no esté conectado a ninguna red de datos, incluyendo redes WiFi, caso contrario no será posible detectar el SmartLink.
3. Windows detecta el aparato automáticamente (la detección puede tardar unos segundos). Para acceder a ello hay que entrar en “Mi PC” y en el apartado de Red saldrá el Smartlink como un icono



4. Pulsando sobre el icono tendremos acceso al entorno web del Smartlink:
Usuario: **admin**
Contraseña: **admin**

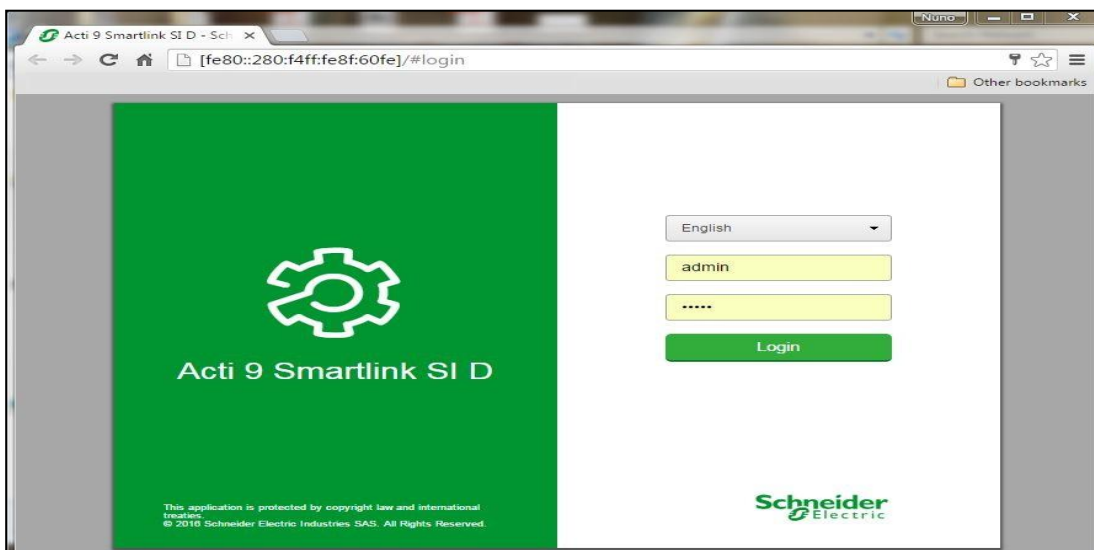

5. Para cambiar la dirección IP que viene por defecto accede al menú **SETTINGS -> COMMUNICATION -> IP CONFIGURATION:**

The screenshot shows the 'SETTINGS' menu with 'COMMUNICATION' selected. Under 'COMMUNICATION', 'IP CONFIGURATION' is highlighted. The 'IPV4' section is expanded, showing options for 'Automatic' (selected) and 'Manual'. The 'Automatic' option is set to 'DHCP'. Below this, the 'IPv4 Address' is set to '169.254.96.254', the 'Subnet Mask' is '255.255.0.0', and the 'Default Gateway' is '0.0.0.0'. The 'IPV6' section is also visible, with 'Enable' checked and 'IPv6 Link-local Address' set to 'FE80::280:F4FF:FE8F:60FE'. The 'DNS' section shows 'Obtain DNS Servers Automatically via DHCP/BOOTP' selected. At the bottom, there are 'Apply Changes' and 'Cancel Changes' buttons, and a note '* Required field'.

6. Acceder al menú **SETTINGS -> COMMUNICATION -> EMAIL SERVICE** caso se desee cambiar el servidor de email por defecto (servidor Schneider Electric) por un servidor de email distinto. El servidor de email es responsable por el envío de Alarmas.

The screenshot shows the 'EMAIL SERVICE' settings page. The 'EMAIL SERVICE' is enabled. The default email server is set to 'schneider-electric mail server'. The 'EMAIL SMTP SERVER SETTINGS' section includes: 'SMTP Server Address' set to 'smartpanels.schneider-ele' (server name or IP address), 'Connection Security Mode' set to 'TLS/SSL', 'SMTP Server Port' set to '465' (range: 1 to 65534), and 'Authentication' unchecked. The 'SMTP Account Login' and 'SMTP Account Password' fields are masked with asterisks. The 'EMAIL SENDER ADDRESS' section shows the 'From Address' set to 'SmartlinkEthernet-8F60FE@smartpanels.schneider-elect'. The 'EMAIL LANGUAGE' section shows the 'Language' set to 'English'. At the bottom, there are 'Apply Changes' and 'Cancel Changes' buttons, and a note '* Required field'. The 'EMAIL TEST' section includes a 'Recipient Address for Test' field and a 'Test' button.

Configurar los sensores PowerTag

1. Conectar los PowerTags a los interruptores correspondientes:

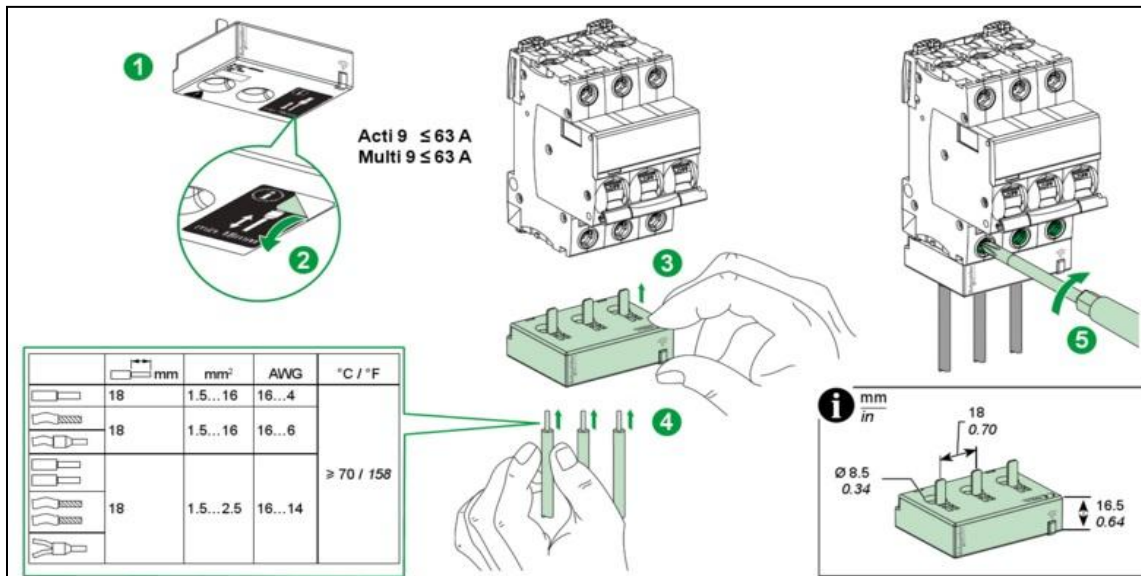

2. Una vez los sensores alimentados proceder a su detección a través del entorno web del Smartlink. Acceder al menú **SETTINGS -> DEVICES -> Start Scanning**:

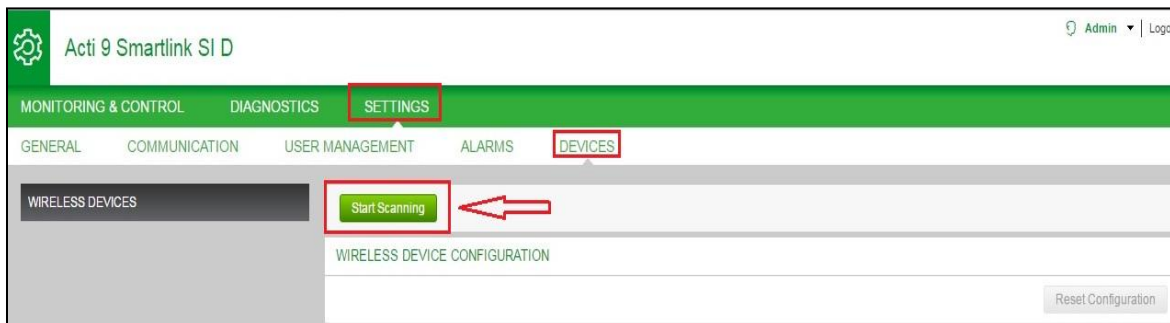

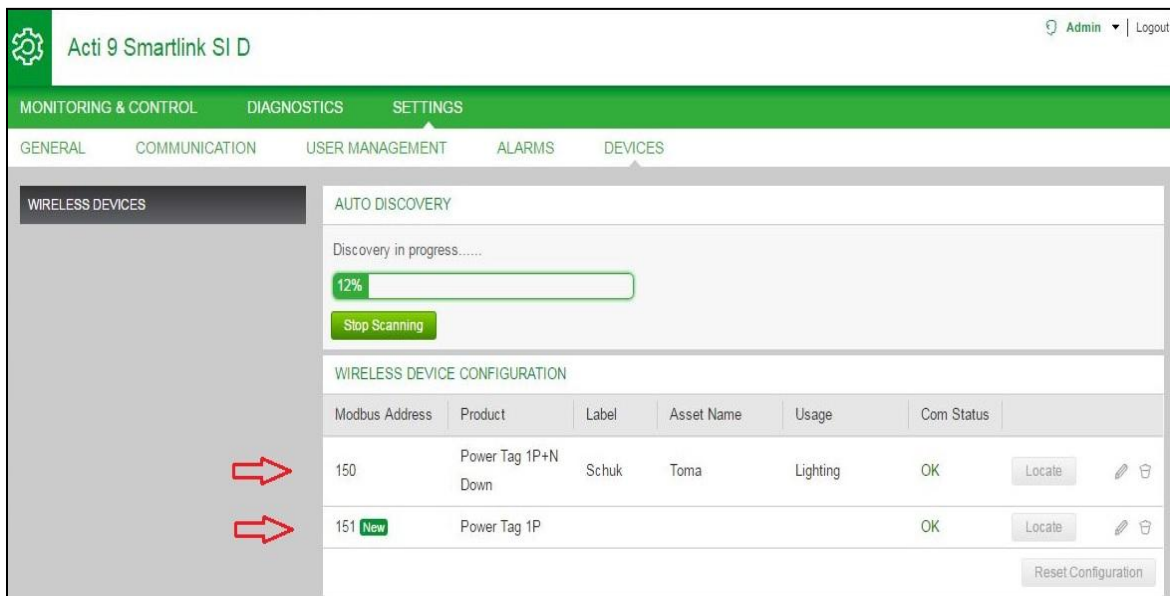

3. Cuando son detectados, los sensores se acoplan automáticamente:



Para editar o borrar los sensores, pulsar en los iconos correspondientes:

Start Scanning

WIRELESS DEVICE CONFIGURATION BORRAR SENSOR

Modbus Address	Product	Label	Asset Name	Usage	Com Status	
150	Power Tag 1P+N Down				OK	Locate  

Reset Configuration

EDIT DEVICE

Asset Name:

Label:

Usage:

Product: *

Phase Sequence: * N

Associate Breaker Rating (A): *

Partial Energy (kWh): * (It may take some time to update value.)

* Required field

Podemos ver el estado y medidas de los sensores en el menú **Monitoring & Control** -> **General:**



Acti 9 Smartlink SI D Admin | Logout

MONITORING & CONTROL DIAGNOSTICS SETTINGS

GENERAL ALARMS

BuildingName

CONSUMPTION

Asset Name	Usage	Product	Gateway	Partial Energy	Load By Phase (I1, I2, I3)
 PT1P	Lighting	Power Tag 1P	mySmartLink-60FE	0.000 kWh	0 %
 Toma	Lighting	Power Tag 1P+N Down	mySmartLink-60FE	0.132 kWh	0 %

 Toma Lighting Power Tag 1P+N Down mySmartLink-60FE 0.057 kWh | 2 %

Real time data :

Total Energy : 0.057 kWh

Partial Energy : 0.057 kWh

Total Power : 0.028 kW

PF : 0.92

I : 0.16 A

V : 229.90 V

P : 0.028 kW

4. En el menú **SETTINGS -> ALARMS** es donde Editamos/borramos los perfiles de alarma o añadimos nuevas alarmas:

ALARM CONFIGURATION

LIST OF ALARMS

Alarms	Asset Name	Usage	Product	Gateway	Label	
Trip Generic						
Voltage Loss						
Overload >80%						
Communication Loss						

Add Alarm

EDIT ALARMS

GENERIC ALARMS FOR THE WHOLE SYSTEM

When: Voltage Loss

...Then Send E-Mail To: admin@example.com guest@example.com

Subject: * Voltage Loss occurred

Message:

```

Event: Voltage Loss
Event Generated On DATE: (year-month-day) 2016-10-07 TIME: 09:22:10
Custom Text:
    
```

* Required field Apply Changes Cancel Changes

Para verificar las alarmas activas accedemos al menú **MONITORING & CONTROL -> ALARMS**:

Acti 9 Smartlink SI D

MONITORING & CONTROL

GENERAL **ALARMS**

BuildingName | You have 1 new alarms

ACTIVE ALARM [Change date & time](#) [Change alarm configuration](#)

Alarm Type	Alarm Value	Asset Name	Usage	Product	Gateway	Email Content	Date & Time
Voltage loss occurred		Toma	Lighting	Power Tag 1P+N Down	mySmartLink-60FE	Email	2000/01/01 00:12:32